

4 Operation

4.1 Checklist before Start

1. Check and ensure the battery has enough power.
2. Ensure the outboard is correctly and firmly installed on the boat.
3. Ensure the propeller is correctly and firmly installed on the outboard.
4. Ensure the battery is correctly and firmly installed on the outboard.
5. Before start, check and ensure the throttle is in zero position.
6. Ensure the throttle can travel smoothly.
7. Check the connections before each trip, ensure the connections are correct and secure, no disconnection or worn or aging connections.
8. Check and ensure the power port is dry to avoid short-circuit.

⚠ Only start the outboard when the propeller is under water.

⚠ If the cable has been immersed in water, please dry the cable thoroughly before connection or turning on power.

4.2 Starting

Step1: Put the kill switch on the pointed position of tiller.

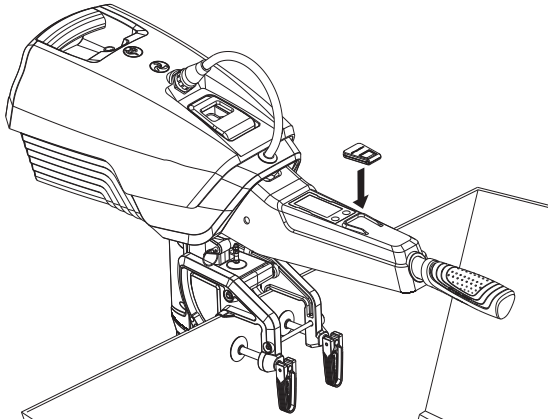

Figure 4-1

Step2: Attach the other end of the kill switch to your wrist or life vest.

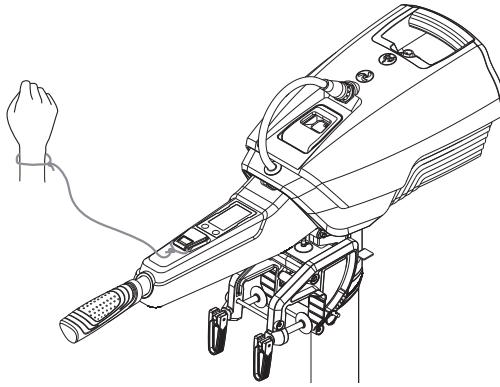

Figure 4-2

- ⚠ For safety consideration, always attach the lanyard of kill switch to your wrist or life vest, so that the outboard will be stopped in the emergency situation of falling.
- ⚠ The kill switch has magnetic field, keep it 50cm/20inch away from pacemakers and other medical implants.
- ⚠ The magnetic field of kill switch may interfere with some electronic instruments, keep it away from these electronic instruments.
- ⚠ Keep the kill switch 50cm/20inch away from magnetic cards (e.g. Credit cards) and other magnetic media.

Step3: Press and hold (≥ 2 secs) the "POWER" button to power on the system.

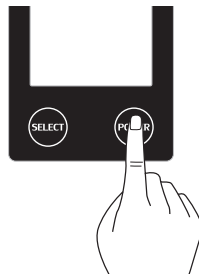

Figure 4-3

Step4: Turn the throttle from neutral position to a desired direction to start the outboard motor. Change the heading direction of the boat by turning the tiller on horizontal level.